



MCI 22K

OWNER'S MANUAL

Quick Start Guide	2
Introduction (Thanks / Warnings / Records)	3
Features / Benefits	4
Controls / Diagrams	5
Initial Setup (Placement / Settings)	7
Operations	8
Maintenance	8
LCD Reminders	9
Disassembly / Assembly	11
Cleaning	11
Troubleshooting	12
Consumer Information	13
Specifications	13
Warranty Information	13

This QUICK START should help you set up your BLS Air Purifier. Please contact your BLS Representative and read the OWNER'S MANUAL for more detailed instructions on set-up and maintenance.

1

Place the unit in the larger room of your environment on a shelf, entertainment center, bookcase or other piece of furniture above six (6) feet. (The higher the better)

REFER TO THIS DIAGRAM FOR STEP 1

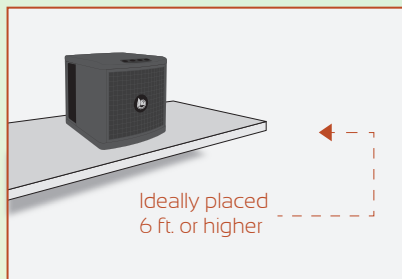

2

Plug the unit in and turn the power "ON". **DO NOT** make any initial adjustments. Allow the unit to run on the *current mode for at least one week before making any adjustments

*The air purifier is doing its job over a period of time based on the size of the environment and the contamination load.

3

If the air purifier is louder than you desire, lower the **FAN SPEED** only. This technology will work extremely well on the lowest setting. It may take a little longer to remove indoor environmental contaminants.

REFER TO THIS DIAGRAM FOR STEPS 2 & 3

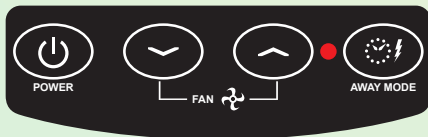

PROTECT YOUR UNIT
EVEN LONGER WITH THE
BLS ENHANCED WARRANTY

With proper maintenance, your BLS Air Purifier should provide many years of cleaner air for you and your family. See our complete line of green chemistries at www.BestLivingSystems.com



SCAN TO REGISTER
YOUR WARRANTY

THANKS

Welcome to a better, healthier environment!

The MCI22K is one of the most advanced air purification systems on the market today. Incorporating MCI™ Multi-Cluster Ionization* technology, high level negative ionization, and electrostatic filtration, the MCI22K reduces particles and inactivates microbes providing a cleaner, healthier environment for you and your family.

The MCI22K is designed to provide years of trouble-free service when properly maintained. This manual will guide you through proper operation of the purifier as well as maintenance procedures. When properly cared for, some parts of the unit will need replaced. Replacement parts can be obtained from your authorized distributor or directly from Best Living Systems, LLC (www.BestLivingSystems.com)

Thank you for purchasing the MCI22K by Best Living Systems.

*Fed. Reg. 4, 320, 186 04/2013

WARNINGS



WARNING: Never operate the unit near a heat source, open flame, or flammable/combustable fluids.



WARNING: Do not operate the unit unless the following are properly installed: DBI CELL, REAR FILTER ASSEMBLIES and the REAR COVER.



CAUTION: The unit should be powered off and the POWER CORD should be disconnected whenever cleaning/disassembling/reassembling/servicing.

RECORDS

PURCHASE DATE: _____

MODEL NUMBER: _____

SERIAL NUMBER: _____

DISTRIBUTOR NAME: _____

DISTRIBUTOR PHONE: _____



Best Living Systems

The MCI22K is one of the most advanced and most versatile whole house air purification systems on the market today.

Using four advanced technologies, the MCI22K helps to eliminate odors, smoke, pollen, dust, bacteria, mold, pet dander, viruses, and much more. Noticeable pollution is eliminated in as little as 15 minutes, and the most difficult pollution in as few as 24 hours.

Unlike other air purifiers that have only one or two ways of eliminating pollution, the MCI22K has four advanced technologies to destroy pollution from the air, embedded in walls, ceilings, floors, carpets, furniture, clothing, on countertops and other surfaces. These technologies help to sanitize everything in the house and reduces or eliminates all odors, including cigarette smoke, mildew, cooking odors, and more.

The advanced variable frequency drive fan system of the MCI22K runs quietly. In addition, the MCI22K is very low maintenance and requires no filter replacement. You simply clean the electrostatic honeycomb and mesh filter with running water! The MCI22K is ideal for any room in your home where airborne and surface pollution may be present.

heavier, making them easier to pull into the home's furnace filter or just fall to the floor to be vacuumed up. Unlike HEPA filters that can filter out particles of .5 microns or larger, the ionizer in the MCI22K can reduce ultra-fine particles, even nano-particles, that are much more dangerous than the larger particles you can see. This means your family breathes easier with fewer particles in the breathing space, less exposure to bacteria, mold and virus particles as well.

3. Electrostatic Filtration: An advanced electrostatic filter is included with the MCI22K to help keep the purifier clean while at the same time filter out particles which clump together thanks to the needlepoint ionization. Unlike expensive HEPA filters, the electrostatic filter is washable and can be used over and over again.

4. Advanced Photo Catalytic Oxidation (PCO) Cell: The PCO technology in the MCI22K not only destroys biological contaminants traveling through the cell, but it produces a purifying plasma which breaks down odors, mold, bacteria and viruses throughout the home or office. Photo Catalytic Oxidation reactors have been proven to reduce dangerous pathogens by over 99% in 24 hours or less. The process is molecular disassociation, which doesn't just cover up the source, it actually breaks the molecule down. The result at the end of the breakdown process is Carbon Dioxide and Water Vapor.

FOUR ADVANCED TECHNOLOGIES

- 1. Advanced Dielectric Barrier Ionization (DBI) Cell:** The DBI technology in the MCI22K not only destroys biological contaminants traveling through the cell, but it produces a purifying plasma which breaks down odors, mold, bacteria and viruses throughout the home or office. Dielectric Barrier Ionization reactors have been proven to reduce dangerous pathogens by over 99% in 24 hours or less.
- 2. Needlepoint Ionization:** The MCI22K generates a continuous stream of millions of negative ions that circulate throughout the home. These ions charge particles of dust, dander, bacteria and viruses; causing them to attract other particles and clump together. As more and more particles come together, they become

ADDITIONAL INFORMATION

Model: Whole House
Maximum Coverage Area: 22,000 Cubic. ft.
Standard Warranty: 1 Year
Enhanced Warranty: 3 Years

www.BLSWarranty.com



UNIT EXTERIOR

UNIT FRONT

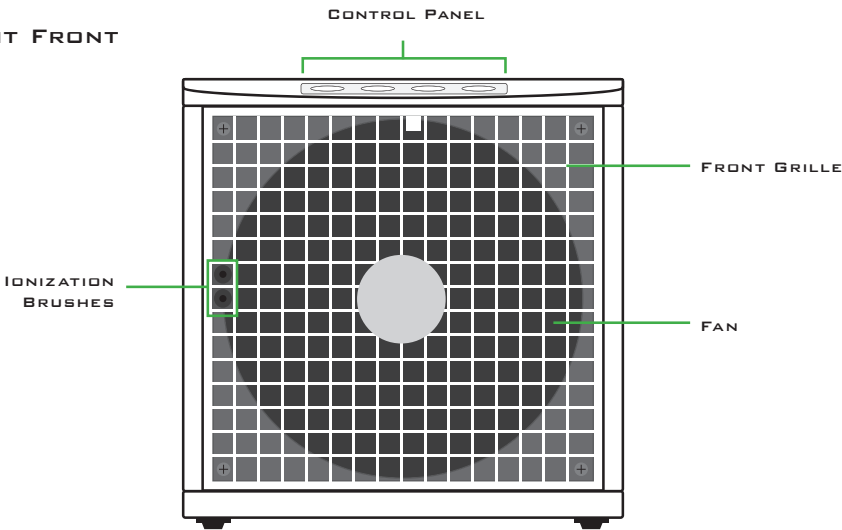

UNIT REAR
(CLOSED)

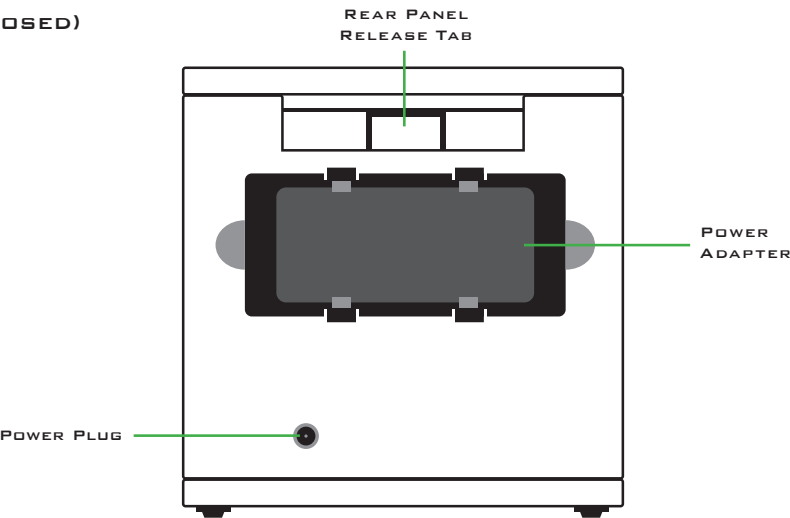

CONTROLS / DIAGRAMS CONTINUED

UNIT REAR (OPEN)

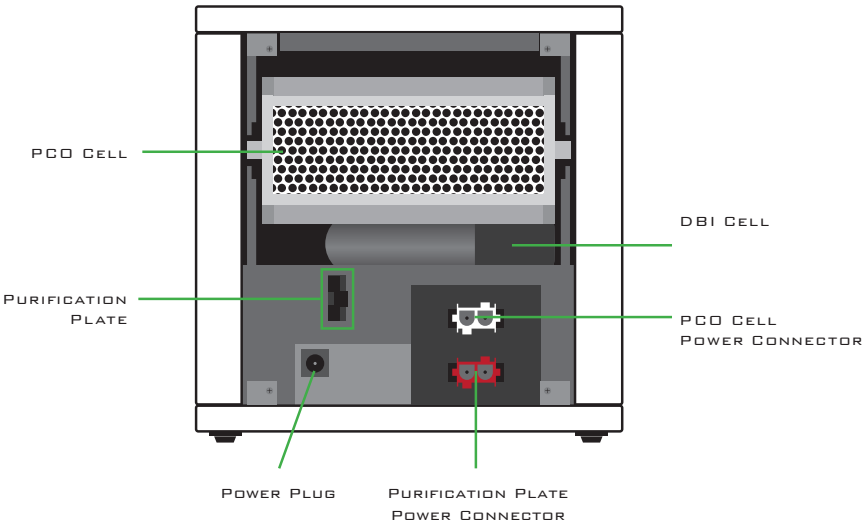

REMOTE

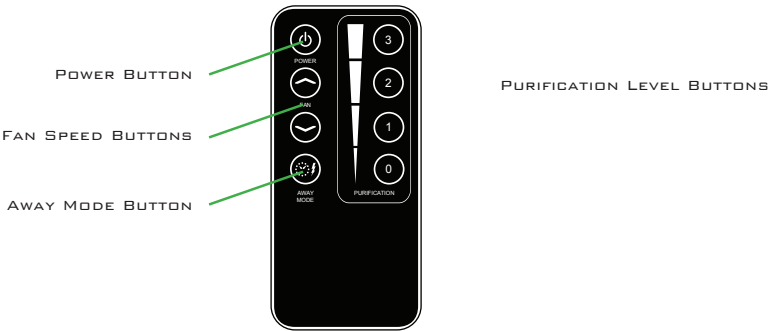

CONTROL PANEL

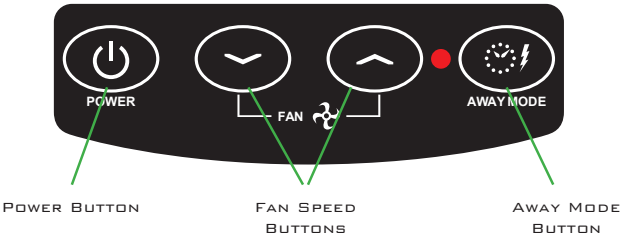

INITIAL SETUP

IDEAL PLACEMENT

When selecting a place for the unit within the environment there are some things to keep in mind. Find a location in the room(s) as far away from the HVAC air return duct as possible, so that the purification produced by the unit is optimally circulated. Place the unit on top of a bookshelf, shelf, or mounting bracket as high as possible leaving twelve to twenty-four inches between the unit and the ceiling. Make sure that there is as much space as possible in front of the unit. Never place an operating unit on the floor.

INITIAL SETTINGS

Before using the unit you will need to determine the area (cubic footage) of the environment. Take into account all rooms which have doors that normally remain open to the environment as the purification that the unit produces does not flow readily through closed doors. The unit can cover a maximum of 22,000 cubic feet. To estimate your homes cubic footage, multiple the HxWxD.

For example: Suppose you have a 12,000 cubic foot house. The living room is attached to the kitchen, three bedrooms, and a laundry room. The kitchen and three bedroom doors remain open the majority of the time but the laundry room and den usually remain closed off from the rest of the house. Together, the laundry room and den have a combined area of 4,000 cubic feet. The area of your environment would be 8,000 cubic feet.

After you have established the placement of your unit and the area of the environment, connect the POWER CORD to the POWER ADAPTER. Connect the POWER ADAPTER PLUG to the unit, plug the POWER PLUG into the wall outlet, turn the unit on (See "CONTROLS"), and set FAN SPEED to the quiet setting.

Lower settings may be desirable if the environment is relatively free of pollutants. A lower setting will still have a high level of purifying power, but it may take longer to work.



TURNING THE UNIT ON

Press the **POWER BUTTON** on the **CONTROL PANEL** or **REMOTE** to turn the unit on.



CAUTION: Never adjust the setting to exceed the square footage of the ventilated space being treated.

CONTROLLING FAN SPEED

Fan speed can be controlled on both the machine's **CONTROL PANEL** as well as with the **REMOTE**.

Three speeds are available (Low, Medium, High) and are adjusted with the **FAN UP/DOWN** buttons.

PURIFICATION LEVEL

Purification level is controlled on the **REMOTE** and adjusts the output of Activated Oxygen (O₃). Four levels are available and will be signified by varying colors on the **CONTROL PANEL**.

DBI CELL REPLACEMENT

The **DBI CELL** does wear out and should be replaced once per year of constant use or when the blue LED lamp goes out, whichever occurs first.

PCO CELL REPLACEMENT

The **PCO CELL** does wear out and should be replaced at least once per year of constant use.

LEVEL 0 (0 - 250ft²): LED IS OFF.



(LEVEL 0 USES ONLY PCO AND IONIZATION TECHNOLOGY.)

LEVEL 1 (250 - 500ft²): LED IS GREEN

LEVEL 2 (500 - 1000ft²): LED IS YELLOW

LEVEL 3 (1000 - 1500ft²): LED IS RED

AWAY MODE

Away Mode is used to treat the toughest odors in your space with higher levels of Activated Oxygen and Ionization. To activate, press the **AWAY MODE BUTTON** on the **CONTROL PANEL** or **REMOTE**.



DO NOT use Away Mode in an occupied space. Prolonged exposure to Activated Oxygen may result in temporary respiratory or eye irritation.

Away Mode is active for 2 Hours before reverting back to previous settings.



Best Living Systems

DISASSEMBLY:

You will need a #1 PHILLIPS SCREWDRIVER.



WARNING! Do not operate the unit unless the following are properly installed: DBI CELL, REAR FILTER ASSEMBLY (with all three pieces in place), and the REAR COVER.



CAUTION! The unit should be powered off and the POWER CORD should be disconnected whenever cleaning/disassembling/reassembling/servicing.

1. Turn the unit off. (See “CONTROLS”)
2. **Removing The Power Cord:**
 - (a) Unplug POWER CORD from wall outlet.
 - (b) Remove POWER ADAPTER PLUG from rear of unit.
3. Clean the exterior of the unit if necessary (See “CLEANING: UNIT EXTERIOR”).
4. **Removing The Rear Cover:**
 - (a) Begin by unplugging the POWER ADAPTER PLUG from the back of the unit.
 - (b) Press down on the tab above the POWER ADAPTER and pull back on the REAR COVER.
5. **Removing The Filter Assembly:**
 - (a) After removing the REAR COVER slide each of the FILTER ASSEMBLIES straight out.
6. **Removing The PCO Cell:**
 - (a) Locate the PCO CELL POWER CONNECTOR on the right of the rear of the unit. Squeeze the tabs on the left and right of the PCO CELL POWER CONNECTOR and gently pull free.
 - (b) Gently slide the PCO CELL out of the unit. Clean if necessary (See “CLEANING: PCO CELL”) and set the PCO Cell aside.
7. **Removing The DBI Cell:**
 - (a) Locate the DBI CELL inside the unit at the front right side of the unit’s interior.
 - (b) Gently push the DBI CELL into it’s POWER CONNECTOR and rotate until it slightly ejects, then remove.
8. Clean the interior of the unit if necessary (See “CLEANING: UNIT INTERIOR”).
9. **Removing The Front Grille:**
 - (a) Locate the four FRONT GRILLE SCREWS in the four corners of the FRONT GRILLE. Using your SCREWDRIVER, carefully remove the four FRONT GRILLE SCREWS. Place the FRONT GRILLE SCREWS where you will find them easily during reassembly.
 - (b) Remove the FRONT GRILLE carefully to ensure that the IONIZATION NEEDLE (in the left center of the front of the unit) is not damaged. Clean the FRONT GRILLE if necessary (using compressed air, vacuum cleaner, a damp cloth, or warm soapy water) and set the FRONT GRILLE aside. Clean the IONIZATION NEEDLE if necessary (See “CLEANING: IONIZATION NEEDLE”).



ASSEMBLY

You will need a #1 PHILLIPS SCREWDRIVER.



WARNING! Do not operate the unit unless the following are properly installed: DBI CELL, REAR FILTER ASSEMBLY (with all three pieces in place), and the REAR COVER.



CAUTION! The unit should be powered off and the POWER CORD should be disconnected whenever cleaning/disassembling/reassembling/servicing.

1. Installing the FRONT GRILLE:

- (a) Gently put the FRONT GRILLE in place on the front of the unit, being careful not to damage the IONIZATION NEEDLE at the left center of the front of the unit.
- (b) Insert the four FRONT GRILLE SCREWS one at a time until they are in place, but not tight. After all four FRONT GRILLE SCREWS are in place tighten them carefully.

2. Installing the PCO CELL:

- (a) Gently slide the PCO CELL - warning side facing towards you - into its slot and push until it locks into place.
- (b) Align the PCO CELL POWER CONNECTOR to the PCO CELL POWER CONNECTOR OUTLET and insert gently until the tabs at the left and right of the PCO CELL POWER CONNECTOR lock into place.

3. Installing the DBI CELL:

- (a) Gently slide the DBI CELL into the POWER CONNECTOR, located on the front right edge of the interior, then push and rotate until it locks into place.

4. Installing the FILTER ASSEMBLY:

- (a) Place each of the FILTER ASSEMBLIES into their slots on the sides with the solid framed side facing out.

5. Installing the REAR COVER:

- (a) Place the REAR COVER into place with the hinges along the bottom in between the hinges of the machine.
- (b) Push the REAR COVER into place until the tab at the top snaps into place.

6. Installing the POWER CORD:

- (a) Insert the POWER ADAPTER PLUG into the rear of the unit.
- (b) Ensure the POWER CORD is properly connected to the POWER ADAPTER
- (b) Insert the POWER PLUG into a wall outlet.

7. Turn the unit ON. Ensure that the unit's settings are adjusted to suit the environment (See "OPERATIONS").



WARNING! Do not operate the unit unless the following are properly installed: DBI CELL, REAR FILTER ASSEMBLY (with all three pieces in place), and the REAR COVER.



CAUTION! The unit should be powered off and the POWER CORD should be disconnected whenever cleaning/disassembling/reassembling/servicing.

UNIT EXTERIOR

Wipe down the exterior with a damp cloth or use compressed air or a vacuum cleaner to remove dust. A non-abrasive cleaner may be used on the surfaces of the exterior, but do not let non-alcohol based cleaners come in contact with the IONIZATION NEEDLE at the left center of the FRONT GRILLE.

FILTER ASSEMBLY

Clean water or compressed air may be passed through the filter assemblies or through the individual parts of the filters when they are disassembled. To disassemble the FILTER ASSEMBLIES grasp the assemblies by the sides of the rim around the filter and carefully separate the rim from the FILTER ASSEMBLY. The three filters (mesh, foam, and honeycomb) can then be removed and cleaned separately. If using water you must allow the filters to dry separately before reassembly. When reassembling, the HONEYCOMB FILTER goes in first, then the FOAM FILTER, and finally the thin MESH FILTER. Then simply reattach the rim to the FILTER ASSEMBLY.

IONIZATION NEEDLE

Using a cotton applicator (Q-Tip), apply a small amount of clear alcohol based cleaner (or rubbing alcohol) to the IONIZATION NEEDLE. You may also use compressed air to blow off any dust that may accumulate near the IONIZATION NEEDLE.

UNIT INTERIOR

Using a damp cloth, a clear alcohol based cleaner, or compressed air/vacuum cleaner carefully clean the walls and components inside of the unit, after completing the DISASSEMBLY procedures.

PCO CELL

Using compressed air or a vacuum blow/suck the dust out of the PCO Cell. Do not use any liquid to clean the PCO CELL.

DBI CELL

Using compressed air or a vacuum blow/suck the dust out of the DBI Cell. Do not use any liquid to clean the DBI CELL.





WARNING! Do not operate the unit unless the following are properly installed: DBI CELL, REAR FILTER ASSEMBLY (with all three pieces in place), and the REAR COVER.



CAUTION! The unit should be powered off and the POWER CORD should be disconnected whenever cleaning/disassembling/reassembling/servicing.

Unit Fails to Turn On

1. Verify that the POWER PLUG is plugged into an operational wall outlet.
2. Ensure that the POWER CORD is properly connected to the POWER ADAPTER
3. Ensure that the POWER ADAPTER PLUG is fully seated in the receptacle on the back of the unit.
4. Verify the POWER BUTTON has been activated on the CONTROL PANEL.
5. If POWER BUTTON on the CONTROL PANEL fails, use the POWER BUTTON on the REMOTE CONTROL. If the unit activates when using the POWER BUTTON on the REMOTE CONTROL but not the CONTROL PANEL the CONTROL PANEL is inoperational. Contact your distributor or Best Living Systems, LLC (www.BestLivingSystems.com).

The PCO Cell is not Lighting Up

1. Ensure the PCO CELL POWER CONNECTOR is properly seated in the PCO CELL POWER CONNECTOR OUTLET (See “DISASSEMBLY/ASSEMBLY”).
2. If the PCO CELL still fails to properly operate, you will need to replace it. Contact your distributor or Best Living Systems, LLC (www.BestLivingSystems.com).

The DBI Cell is not Lighting Up

1. Ensure the DBI CELL is properly seated in the DBI CELL POWER CONNECTOR (See “DISASSEMBLY/ASSEMBLY”).
2. If the DBI CELL still fails to properly operate, you will need to replace it. Contact your distributor or Best Living Systems, LLC (www.BestLivingSystems.com).

Ionization Needle Creates an Electrical Arc

The IONIZATION NEEDLE needs cleaned (See “CLEANING: IONIZATION NEEDLE”). Be sure to complete all of the cleaning procedures described in “CLEANING” every 30 days of operation.

Fan Does Not Operate Properly

1. Try adjusting the fan speed using the CONTROL PANEL or REMOTE CONTROL
2. Remove the FRONT GRILLE (See “DISASSEMBLY/ASSEMBLY”) and ensure there are no obstructions to the movement of the FAN. Clean it thoroughly and also clean the mount that it sits on.
3. If FAN continues to operate improperly or not at all, contact your distributor or Best Living Systems, LLC (www.BestLivingSystems.com).

CONSUMER INFORMATION

Best Living Systems declines all responsibility for all damages arising from improper use of the unit or in case of tampering with the unit.

SPECIFICATIONS**Unit**

- Size: 6 3/4" high x 6 1/2" wide x 7" deep
- Weight: 3 lb.
- Coverage: Up to 22,000 Cubic Feet *

Power Cord

- Fuyuang Switching Power Supply
- Model: FY 1503000
- Input: 100-240VAC 50/60Hz 2.5A
- Output: 15VDC 3A
- See the power supply label for certifications and warnings.

PCO Cell

- Normal Mode Output: < 0.02 ppm ozone (ambient room concentration)

DBI Cell

- Normal Mode Output: Multi-Cluster Ionization

Ionization Needle

- 6 KV DC Needle Ion Generator

* Depending on variables such as the severity and frequency of pollution, flow of air in the environment, humidity, and temperature.

LIMITED WARRANTY

Your MCI22K Air Purifier is warranted to be free from all defects in material and workmanship in normal household use for a period of (1) year from date of purchase. The warranty is granted only to the original purchaser and members of his or her immediate household. The warranty is subject to the following provisions.

This warranty does not cover parts of the Air Purifier that require replacement under normal use. This includes the rear filter assemblies. Although the DBI cell requires periodic replacement, the cell is warranted for the same 1 year period as the purifier.

Any damages or malfunctions caused by negligence, abuse, or use not in accordance with the Owner's Manual are not covered by this warranty. Likewise, any defects or damages caused by unauthorized service or the use of other than Genuine Best Living Systems parts are not covered.

Best Living Systems will, at its option, repair or replace a defective Air Purifier or part(s) for the Air Purifier that is covered by this warranty. As a matter of warranty policy, Best Living Systems will not refund the customer's purchase price.

To obtain warranty service you must return the defective Air Purifier or Air Purifier parts along with proof of purchase to the Best Living Systems Authorized Warranty Station. All transportation charges on parts, or units, submitted under this Warranty shall be borne by purchaser. Unless this Warranty is expressly renewed or extended by Best Living Systems, any repaired or replaced part of unit shall be warranted to the original purchaser only for the length of the unexpired portion of the original warranty.

Further Limitations And Exclusions Are As Follows

Any warranty that may be implied in connection with your purchase or use of the Air Purifier, including any warranty of merchantability or any warranty for Fitness For A Particular Purpose is limited to the duration of this warranty. Some states do not allow limitations on how long an implied warranty lasts, so the above limitations may not apply to you.

Your relief for the breach of this warranty is limited to the relief expressly provided above. In no event shall Best Living Systems be liable for any consequential or incidental damages you may incur in connection with your purchase or use of the Air Purifier. Some states do not allow the exclusion or limitation of incidental or consequential damages, so the above limitation or exclusion may not apply to you.

This Warranty gives you specific legal rights, and you may also have other rights which vary from state to state.

Registration

Please register your new Best Living Systems Air Purification product within 10 days of purchase by visiting www.BLSWarranty.com. Registering your new Best Living Systems product entitles you to the most up-to-date Best Living Systems product warranty and promotion information and discounts on replacements parts.

**Best Living Systems**



Best Living Systems

Best Living Systems, LLC
www.BestLivingSystems.com



CERTIFIED BY NORMI™ WHEN USED TO QUALIFY FOR THE NORMI™ CERTIFICATE OF SANITIZATION

MANUFACTURED TO BEST LIVING SYSTEMS SPECIFICATIONS BY:

